

Instructions



Herman SHY3 Signe Hytte 2022

Congratulations with your new Herman table lamp, designed in 2022 by Signe Hytte. We hope you will enjoy using this product. Please follow these instructions to ensure correct installation. If you have any questions or comments, please do not hesitate to contact us by mail at:

info@andtradition.com

Herman SHY3

Signe Hytte

2022

Please read these instructions carefully and retain them for future reference to ensure that the product is used correctly. For your own safety, please study each step of this instruction manual first. &Tradition is not responsible for any faults or damages caused by not following these instructions correctly. Do not modify this product in any way.

Contents

- A Lamp
- B Shade brackets
- C Lamp holder ring
- D Glass shade (comes in separate box)

Tools needed

- Bulb type E14

Safety precautions

- Dispose of plastic bag from packaging and do not allow children to play with it.
- Keep the product out of the reach of children.
- The lamp is only suitable for indoor use.
- Consult a professionally qualified electrician if in any doubt.
- Do not place the cable within reach of small children or anywhere with a risk of falling over it.
- If the external cable or cord of this lamp is damaged, it must be replaced by the manufacturer or a similar qualified person in order to avoid a hazard.

Cleaning instructions

- Wipe the surface of the shade with a dry cloth.
- Do not use any abrasive cleaning tools such as steel wool, scouring sponges or stiff brushes.
- Never use strong cleaning agents such as white spirit, turpentine, household glass cleaner or cellulose thinners.

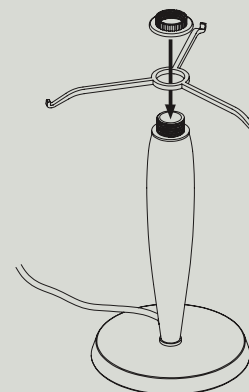
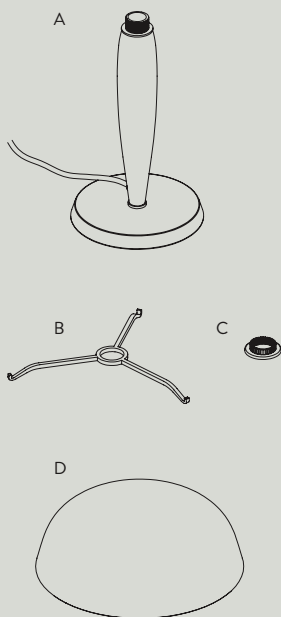

Step 1

Place the shade bracket over the socket and screw the lamp holder ring back on the socket to secure it.

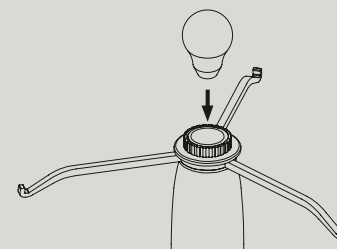

Step 2

Place the light bulb on the socket and ensure that it sits tight.

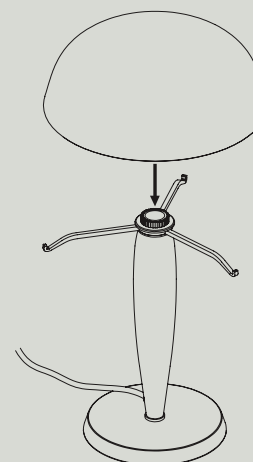

Step 3

Carefully place the shade onto the shade bracket.

For indoor use only
E14 maximum 25W
Bulb not included

&Tradition®